



Legend

-  Signed Detour Route
-  Road Open to Traffic
-  Road Closed to Traffic

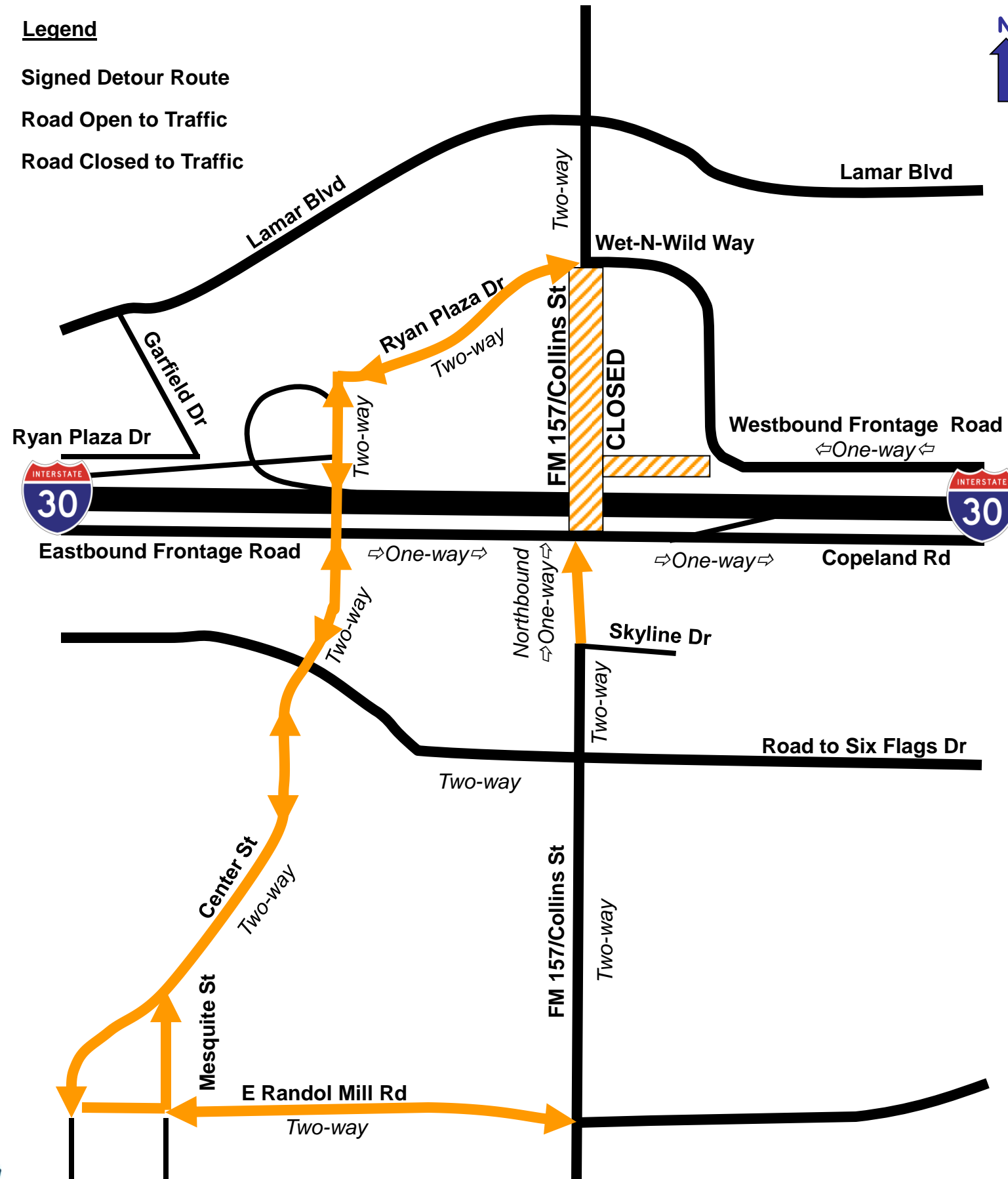

FM 157/COLLINS STREET DETOUR

TRAFFIC CONTROL PLAN

START: July 2009

END: Fall 2009

WHY: Expedite mobility on FM 157/Collins Street between Lamar Boulevard and Skyline Drive nearly 4 months ahead of schedule with completion this fall.

WHAT: Northbound FM 157/Collins Street Detour Route
Northbound FM 157/Collins Street through traffic will be detoured to Center Street across the bridge over I-30 to Ryan Plaza Drive east to FM 157/Collins Street.

FM 157/Collins Street north of Road to Six Flags Drive to Skyline Drive will remain in two-way operation with full access to both Skyline Drive and the Lincoln Square Mall entrance.

Southbound FM 157/Collins Street Detour Route
Southbound through traffic will be detoured at Ryan Plaza Drive west to Center Street across the new I-30/Center Street bridge. Motorists then may use either Road to Six Flags Drive or Randol Mill Road to access FM 157/Collins Street to the east.

Westbound Frontage Road to FM 157/Collins Street
The westbound frontage road will be directed along Wet-N-Wild Way to the intersection with FM 157/Collins Street and Ryan Plaza Drive. Motorists destined for southbound FM 157/Collins Street will continue west onto Ryan Plaza Drive following the detour route.



Prepared: July 7, 2009